

Grand Rapids



MSU Facility for Rare Isotope Beams

2016

Executive Summary

We Understand Your Event Objectives

We welcome this chance to show you why Grand Rapids is an ideal location to host the JACoW 2016 Team Meeting. Experience Grand Rapids has considered everything you've shared with us about your group, discussed how we can best meet your needs and prepared a proposal that explains how bringing your meeting here offers the best value to the MSU Facility for Rare Isotope Beams.

You know what it takes to put on a successful meeting, but you need help pulling everything together. Experience Grand Rapids is your "boots on the ground," taking care of the details and letting you focus on the big picture. Beyond coordinating logistical support and putting you in touch with the right people, our convention sales and services team helps you deliver a quality meeting at or below budget. At the end of the day, we know that you are responsible for the success of the JACoW 2016 Team Meeting. Our team knows what is at stake and works closely with you to make everything run smoothly.



Factors for Success

We listened when you told us about the factors that will help make the JACoW 2016 Team Meeting a successful meeting for your attendees. Specifically, we know that the following issues are most important as you select your destination:

- **Air Service:** Because many of your attendees will be flying, you will want to ensure that their travel experience is convenient and cost effective. An important consideration in your site selection is the availability of many non-stop flights from a wide variety of airlines. Once attendees arrive, you want them to have easy access to event activities from the airport.

Executive Summary

- **Amenities that Matter:** When attendees are at the JACoW 2016 Team Meeting, you will want every moment to be a positive experience. Your selected destination must include amenities that ensure convenience, comfort and accessibility.
- **Available Activities:** You are looking for a destination where you can offer a wide variety of activities that appeal to the entire group, as well as to individual preferences.
- **Under one Roof:** For convenience, and to encourage networking and team building, you would like to conduct all meeting activities at one location. Having everyone remain under one roof is the best way to make JACoW 2016 Team Meeting a successful affair.

We appreciate the importance of this event to the MSU Facility for Rare Isotope Beams and our proposed solution satisfies the key requirements above.

Amway Grand Plaza Hotel

This Four-Star hotel conveys the elegant history of the 1920s and is known for its top-notch customer service and attention to detail. The [Amway Grand Plaza Hotel](#) is within walking distance of our cool and vibrant downtown district where you will find arts, culture, museums and over 90 restaurants. The hotel has 682 guest rooms, nine restaurants and lounges, boutiques, spa and pool all under the convenience of one roof. As well, a skywalk connects the hotel to the DeVos Place convention center.

Amy, we can confidently tell you that Grand Rapids will exceed your expectations. But don't just take our word for it. We host hundreds of groups each year and will gladly put you in touch with other people who have selected our wonderful city for their events.

Thank you for considering Grand Rapids for the JACoW 2016 Team Meeting. We will contact you within a week to answer any questions you might have about the following proposal.

Proposals



Amway Grand Plaza Hotel Group Accommodations Agreement

This is a formal confirmation of the arrangements we are holding for the MSU Facility For Rare Isotope Beams over the dates of October 16, 2016 - October 21, 2016.

Name: Ms. Janell Kebler
Organization: MSU Facility For Rare Isotope Beams
Address: 640 S. Shaw Lane
Office 2135
City/State: East Lansing, Mi 48824-1321
Phone: 517-908-7726

Arrival: October 16, 2016 **Departure:** October 21, 2016

Guest Room Block:

Day:	Sunday	Monday	Tuesday	Wednesday	Thursday	Total
Date:	10/16/16	10/17/16	10/18/16	10/19/16	10/20/16	
Guest Rooms Blocked:	15	15	30	30	30	120

Arrival and departure dates, numbers of guest rooms, suites booked per day, and total number of rooms booked ("room nights") are specified above. Guest room pick-up will be reviewed with you prior to your arrival.

Reservation Process: Individual Call In

The Amway Grand Plaza Hotel is pleased to offer the use of our online group reservations system powered by Passkey. All reservations will be made, modified or canceled by individuals on-line at a URL to be established and published to potential attendees through the planner's meeting website or via email. By providing the group name, individuals will also be able to make reservations by calling toll free 1-800-253-3590. Reservations must be made on or before the cut-off date of September 16, 2016 in order to be eligible for the group rate.

The Amway Grand Plaza Hotel will be able to supply a username and password to provide the planner with 24/7 on-line access to the group's information and reports.

Group Block Cut-off: September 16, 2016

Guest Room Rates:

We are pleased to confirm the following special net rates:

<u>Room Occupancy</u>	<u>Rate</u>
Single (1 person)	\$139.00
Double (2 persons)	\$139.00
Triple (3 persons)	\$139.00
Quad (4 persons)	\$139.00

For comparison, below is the current GUEST ROOM RACK RATE for 2015:

*Single/Double - \$250.00**

** Hotel Rack Rates are subject to change without notice.*

MSU Facility For Rare Isotope Beams agrees that the Amway Grand Plaza Hotel will be the only recommended hotel for room accommodations.

Guest room rates are subject to an 9% occupancy tax and 6% state tax. (Tax rates are subject to change)

Billing Information:

Guest Room and Tax: **Individual pays own**

Incidentals: **Individual pays own**

Banquet Charges: **Master Account**

Function Room/A.V. Set-up Fees: **Master Account**

Function Rooms:

Date	Start Time	End Time	Function	Room	Setup	Ag
Sunday						
10/16/2016	8:00 AM	5:00 PM	General Session	Haldane	Classroom	20
Monday						
10/17/2016	8:00 AM	5:00 PM	General Session	Haldane	Classroom	20
Tuesday						
10/18/2016	8:00 AM	5:00 PM	General Session	Haldane	Classroom	40
10/18/2016	8:00 AM	5:00 PM	Break Out	Kendall	Conference	10
10/18/2016	8:00 AM	5:00 PM	Break Out	Berkey	Conference	10
10/18/2016	8:00 AM	5:00 PM	Break Out	Nelson	Conference	10
10/18/2016	8:00 AM	5:00 PM	Break Out	Winchester	Conference	10
Wednesday						
10/19/2016	8:00 AM	5:00 PM	Break Out	Winchester	Conference	10
10/19/2016	8:00 AM	5:00 PM	Break Out	Berkey	Conference	10
10/19/2016	8:00 AM	5:00 PM	Break Out	Nelson	Conference	10
10/19/2016	8:00 AM	5:00 PM	Break Out	Kendall	Conference	10
10/19/2016	8:00 AM	5:00 PM	General Session	Haldane	Classroom	40
Thursday						
10/20/2016	8:00 AM	5:00 PM	General Session	Haldane	Classroom	40
10/20/2016	8:00 AM	5:00 PM	Break Out	Kendall	Conference	10
10/20/2016	8:00 AM	5:00 PM	Break Out	Nelson	Conference	10
10/20/2016	8:00 AM	5:00 PM	Break Out	Berkey	Conference	10
10/20/2016	8:00 AM	5:00 PM	Break Out	Winchester	Conference	10
Friday						
10/21/2016	8:00 AM	5:00 PM	Break Out	Winchester	Conference	10
10/21/2016	8:00 AM	5:00 PM	Break Out	Berkey	Conference	10
10/21/2016	8:00 AM	5:00 PM	Break Out	Nelson	Conference	10
10/21/2016	8:00 AM	5:00 PM	Break Out	Kendall	Conference	10
10/21/2016	8:00 AM	5:00 PM	General Session	Haldane	Classroom	40

Total Function Room/Set-up Fees: Complimentary Meeting Space

Settlement:

1. All charges, less any advance deposit, must be paid upon departure. However, a master account for direct billing of Food and Beverage, room and miscellaneous charges connected with your program, can be established with the Hotel subject to advance credit approval. Requests for direct billing must be accompanied with a completed credit application and received no later than 60 days prior to the program.
2. For your protection, it is important that our Convention Service Department receive a list of individuals who have master account signing privileges along with any expenditure limits that you may wish to impose.

Agreement Decision Date:

These arrangements will be reserved on your behalf until **December 28, 2015**, by which time the Hotel must have received a signed copy of this agreement and agenda verifying your acceptance. In the event we have a request for your dates from another organization prior to **December 28, 2015**, we will contact you for a definite decision to confirm or release these dates in writing within 48 hours. If we have not received your confirmation by **December 28, 2015**, the Hotel will release all space for resale.

Current Overnight Guest Parking Rates:

- Self-parking \$19.00 per day
 - Valet parking \$29.00 per day (unlimited in/out privileges)
- * Parking rates are subject to change without prior notification.

Complimentary Guest Room Accommodations:

The Hotel is pleased to offer:

- Complimentary Internet in Guest Rooms
- Complimentary Fitness Center Usage
- Complimentary Meeting Space
- 2 upgrades to suites at the Group Rate

Adjustments to Concessions:

In the event of reductions in the Room Night Commitment of more than 80%, the Hotel may adjust any concessions previously offered in this Agreement, including those concessions offered on a complimentary basis, and may also adjust the Function Space in direct proportion to the reduction in the Room Night Commitment.

Arrangements

Guest Rooms:

1. Any reservations received after **September 16, 2016** will be accepted on a space available basis and may be subject to Hotel rack rates.
2. For groups making reservations by rooming list, the Hotel requires our reservation form and format be used.
3. In the event your organization wishes to use another reservation form or an alternative housing bureau, the Hotel must approve your form prior to printing and distribution to your membership.
4. We recommend that our Convention Service Manager be included on your delegate mailing list to keep us informed of when reservations are likely to begin arriving.
5. Reservations must be accompanied by a valid major credit card, check or money order made payable to the Amway Grand Plaza Hotel. The amount of deposit required equals the value of the first night's accommodation, including tax. Guaranteed reservations are held for arrival until 6:00 AM on the day following the first night reserved. A \$50.00 early departure fee is assessed upon check-out to all early departed reservations.
6. Deposits are refundable if notice of cancellation is received by the Hotel Reservations Department at least 48 hours prior to the date of expected arrival.
7. Unless direct billing has been approved, guests are required to present a valid credit card upon registration. If a credit card is not presented upon check-in, a \$25.00 refundable deposit is required on all cash and check paying guests.
8. Guest check-in is 4:00 PM; however, early arrivals will be accommodated based on availability. Check-out time is 11:00 AM. Requests to retain room beyond that hour should be directed to our Front Desk. Depending on room availability, a late departure charge will apply.

Food and Beverage Guidelines:

- 1) All food and beverage consumed on the premises of the Hotel or DeVos Place must be provided by the Hotel. Group food and beverage functions will be serviced by our Banquet Department.
- 2) Group food and beverage service in guest rooms or suites will be provided by our Room Service Department. Guest room rates are determined with the understanding that all food and/or beverage items served in the guest rooms will be provided by the Hotel. The Hotel reserves the rights to increase the room rate in any room where food/beverage items are served that were not provided by the Hotel.
- 3) Firm food and beverage pricing will be established three months prior to your event dates. Food and beverage prices are currently subject to a 6% state tax and a 22% service charge. Taxes and service charges are subject to change without notice.
- 4) When charges are made on a per person basis, a guaranteed attendance must be communicated by noon three business days prior to your function. Increases over 2% received after the guarantee cut off over will be assessed an additional 20% premium per meal.
 - a) Special Meal Request: special meal guarantees are required by noon 3 business days prior to your function. Any special meals requested after the 72 hour cut off will be billed at the menu price and will be added to your original guarantee count.
- 5) Function rooms are assigned based on the number of guests anticipated. The Hotel reserves the right to re-assign function rooms based on actual attendance.

Exhibit Space Charges:

Should an exhibit area be added to your program, it will be necessary to discuss availability of meeting space and applicable charges with your Sales Manager.

A daily exhibit space charge of \$50.00 per booth (up to 8'x10' in size) will apply. This charge does not include the tables, chairs or pipe and drape. See the table below for additional services.

Additional requirements list:

Covered six foot table and up to two chairs	\$20.00/day
Covered eight foot table and up to two chairs	\$30.00/day
Electrical Power	Starting at \$15.00/day
Drayage	\$15.00/cart and \$25.00/pallet

Should MSU Facility For Rare Isotope Beams utilize a decorator to provide tables, chairs or pipe and drape, the \$50.00 per booth exhibit space charge will still apply.

Hand carried exhibit items can be brought to our exhibit area through the Hotel's motor lobby with bell staff assistance available upon request. Larger exhibit items must be delivered through the Hotel's loading dock with specific delivery and pick up times coordinated by the Convention Service Manager assigned to work with you. This exhibit material should be scheduled to arrive and depart the Hotel during established set up and move out times since there are limited storage areas within the Hotel.

Contact your Convention Services Manager for mailing materials and customized form you may include with your exhibitor package.

Audio Visual Guidelines:

All Audio Visual used on the premises of the Amway Grand Plaza Hotel is to be contracted through our Audio Visual Department.

For your convenience we offer full service, on-site, affordable audio visual equipment and service through our in-house Audio Visual Department. You will find our Audio Visual Department to be well trained, professional, accommodating and flexible. Please feel free to contact our Audio Visual Sales Manager, Michael Cassell, direct at (616) 776-6488. All Audio Visual charges are subject to 6% state sales tax and 22% service charge.

General Liability:

The Hotel Reserves the right to inspect and control all functions. Damage to the Hotel premises at organizational sponsored events will be your organization's responsibility. The Hotel is not responsible for loss or damage to any samples, displays, properties, or personal effects brought into the Hotel.

Organizational signage is permitted only in the meeting room areas of the Hotel. Signs must be professionally printed and sign locations approved by our Convention Service Department. Signs are not allowed to be affixed to any part of the Hotel.

Cancellation/Attrition Clause:**Guest Rooms**

The Amway Grand Plaza Hotel is relying upon MSU Facility For Rare Isotope Beams to use 120 total room nights. MSU Facility For Rare Isotope Beams agrees that a loss will be incurred by the Hotel should there be a reduction greater than 10% in total room nights actually used.

Should the room nights actually used by MSU Facility For Rare Isotope Beams be less than 90% of the total room nights, MSU Facility For Rare Isotope Beams agrees to pay, as liquidated damages and not as a penalty, the difference between 90% of the total room nights and MSU Facility For Rare Isotope Beams actual usage of rooms, multiplied by the average group room rate.

The estimated revenue of the guest room block has been calculated to be **\$16,680.00**.

120 room nights at \$139.00 = \$16,680.00

Arbitration:

In the unlikely event any controversy of claim should arise out of or relating to this contract, or the breach thereof, it shall be settled by arbitration in the state of Michigan in accordance with the Rules of American Arbitration Association, and judgment upon the award rendered by the Arbitrator(s) may be entered in any Court having jurisdiction thereof.

Indemnify:

Group agrees to indemnify, defend and hold Amway Grand Plaza Hotel Corporation, its officers, directors, employees, representatives and agents harmless with respect to all liability, loss, damage, claims and expenses (including reasonable attorney's fees) arising out of the acts or omissions of the Group, its members, employees, contractors, agents or representative.

Acts of God:

The performance of this Agreement by either party is subject to acts of God, government authority, disaster, civil disorders, or other emergencies, any of which may make it illegal or impossible to provide the facilities and/or services for your meeting. It is provided that this Agreement may be terminated for any one or more of such reasons by written notice from one party to the other without liability.

Warranty of Authority:

The undersigned is authorized to sign this acceptance on behalf of the organization, and the organization represents and warrants that the undersigned person is a duly appointed agent for this event and is fully empowered to bind the organization to all provisions contained in this agreement, and that no further action is required on the organization's part to enter into this agreement.

Please sign and return the original copy of the agreement

Client Signature:

Client Name: Ms. Janell Kebler

Title/Position:

Organization:

Date:

Hotel Representative: Chris Schroeder, CMP

Title/Position: National Sales Manager

Date:

**Amway Grand Plaza Hotel
187 Monroe NW
Grand Rapids, MI 49503
616-776-6400
Fax 616-776-6496**

Amway Grand Plaza Hotel

187 Monroe Ave. NW • Grand Rapids, MI 49503
 (616) 774-2000 • (800) 253-3590
 Fax: (616) 776-6400
www.amwaygrand.com

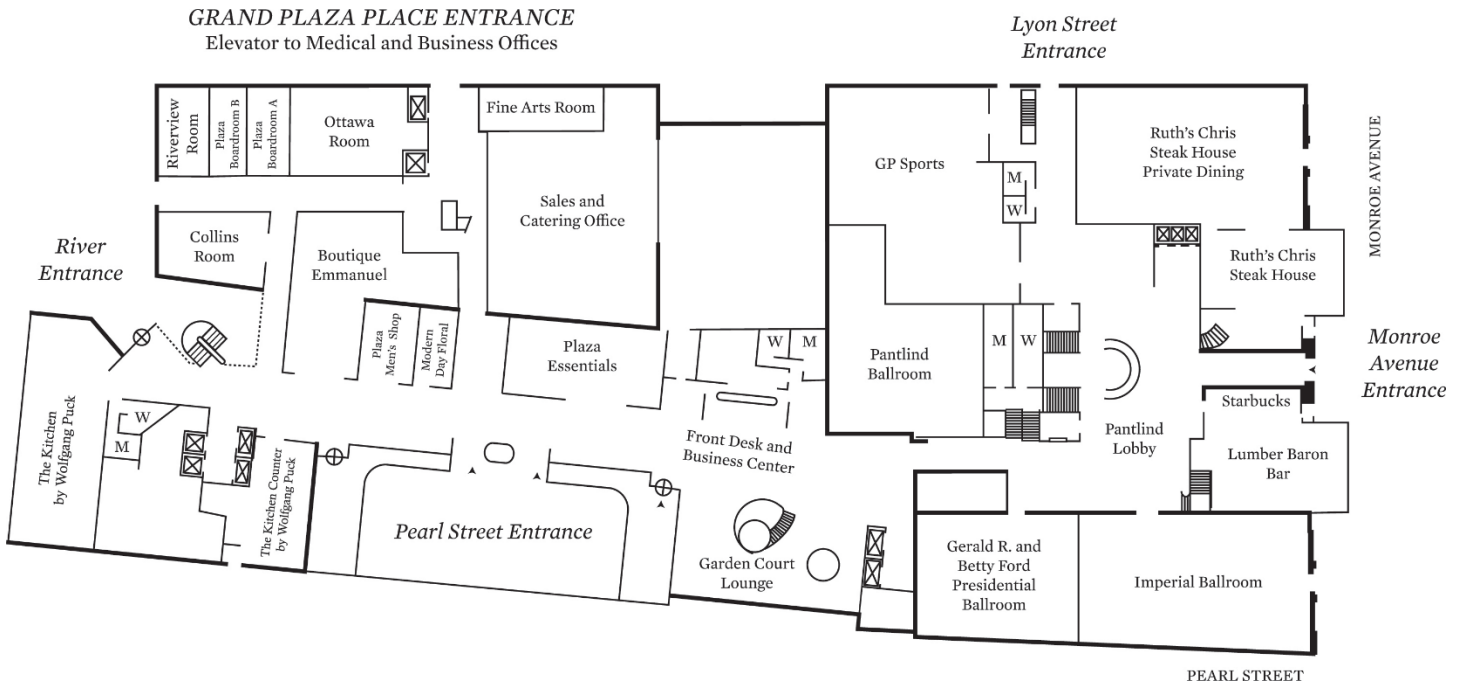

Room Name	Dimensions	Sq. Ft.	Ceiling	Banquet	Classroom	Reception	Theatre
President Gerald R. Ford	45' x 45'	2,025	20'	160	130	250	220
Fine Arts Room	28' x 16'	448	8' 6"	0	0	0	0
Ottawa Room	29' x 38'	1,100	8' 6"	70	36	125	72
Riverview Room	29' x 17'	493	8' 6"	40	30	50	55
Plaza Boardroom A	29' x 14'	406	8' 6"	20	15	25	20
Plaza Boardroom B	14' x 17'	238	8' 6"	10	12	20	15
29th Floor Pinnacle Room	29' x 31'	835	8'	50	38	75	60
26th Floor Rotunda	26' x 25'	650	9'	40	30	70	40

Amway Grand Plaza Hotel

187 Monroe Ave. NW • Grand Rapids, MI 49503
 (616) 774-2000 • (800) 253-3590
 Fax: (616) 776-6400
www.amwaygrand.com

AMWAY GRAND PLAZA

CONCOURSE LEVEL - 2ND FLOOR

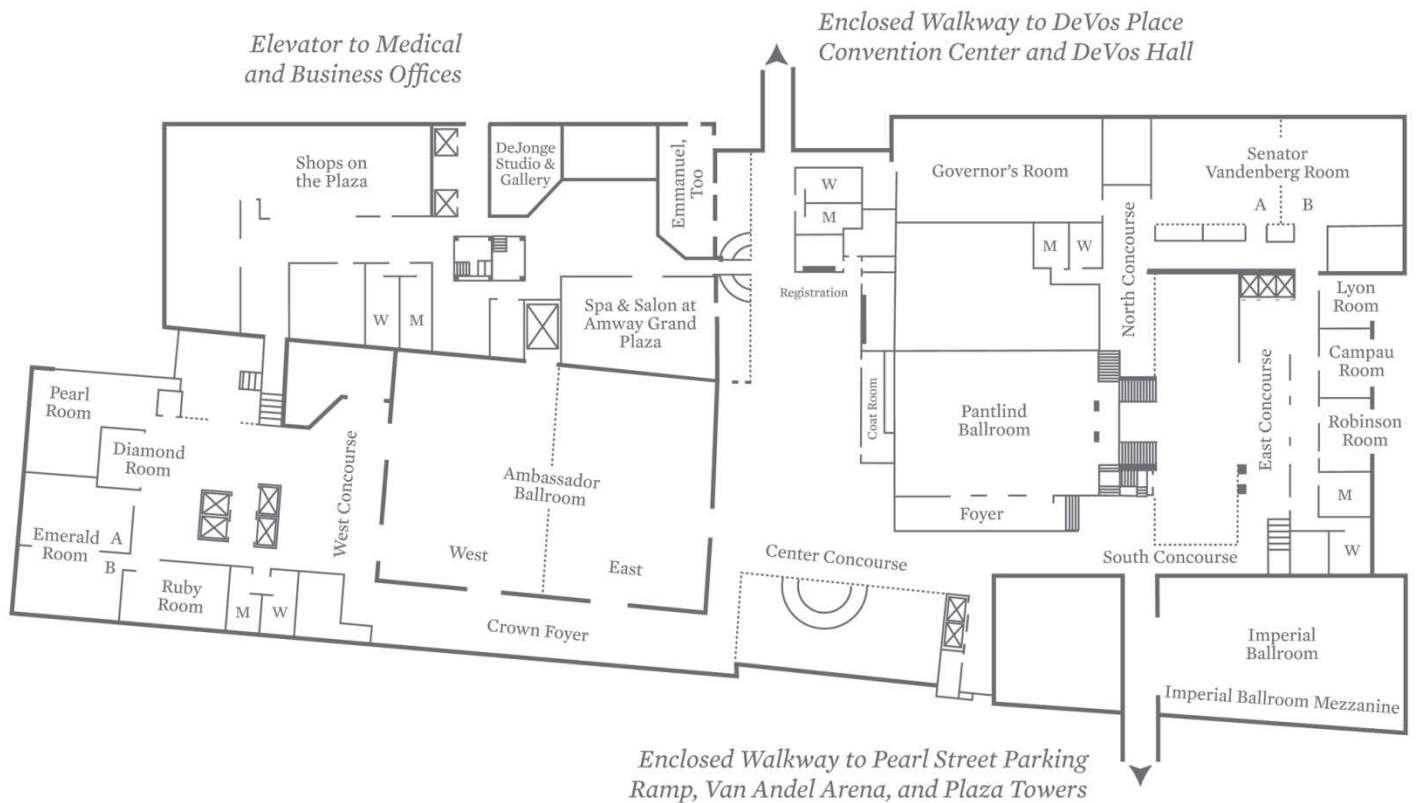

Amway Grand Plaza Hotel

187 Monroe Ave. NW • Grand Rapids, MI 49503
 (616) 774-2000 • (800) 253-3590
 Fax: (616) 776-6400
www.amwaygrand.com



Room Name	Dimensions	Sq. Ft.	Ceiling	Banquet	Classroom	Reception	Theatre
Ambassador Ballroom	125' x 70'	8,750	16'	720	600	1,150	1,100
Ambassador East	62' x 70'	4,375	16'	350	260	550	500
Ambassador West	62' x 70'	4,375	16'	350	260	550	500
Campau Room	23' x 14'	329	9'	20	16	40	25
Diamond Room	19' x 15'	292	10'	10			
Emerald Room	57' x 37'	2,138	9'	150	120	224	220
Emerald Room A	24' x 37'	900	9'	70	48	100	90
Emerald Room B	33' x 37'	1,238	9'	70	56	100	100
Imperial Ballroom (Main)	56' x 55'	3,300	8' – 30'	180	100	300	190
Imperial Ballroom (Mezzanine)	56' x 10'-15'	1,800	15'	60		80	
Lyon Room	18' x 16'	296	9'	10	12	35	16
Pantlind Ballroom	75' x 46'	3,450	35'	290	224	500	400
Pantlind Foyer	45' x 13'	585	8'	40		70	
Pearl Room	38' x 29'	1,132	10'	60	58	110	110
Governor's Room	79' x 37'	2,923	10'	210	168	325	270
Robinson Room	29' x 13'	434	9'	30	20	50	30
Ruby Room	32' x 19'	625	10'	30	31	50	40
Senator Vandenberg Room	94' x 35'	3,290	10'	230	187	350	290
Senator Vandenberg Room A	47' x 35'	1,645	10'	100	74	175	140
Senator Vandenberg Room B	47' x 35'	1,645	10'	100	74	175	140
Concourse/Foyer Areas – Second Floor							
Center Concourse	95' x 55'	5,225	18'				700
Crown Foyer	125' x 27'	3,375	16'				500
East Concourse	93' x 19'	1,767	12'				200
North Concourse	62' x 21'	1,302	10'				100
West Concourse		2,500	10'				150
Registration Area			10'				

Amway Grand Plaza Hotel

187 Monroe Ave. NW • Grand Rapids, MI 49503
 (616) 774-2000 • (800) 253-3590
 Fax: (616) 776-6400
www.amwaygrand.com

AMWAY GRAND PLAZA

CONFERENCE LEVEL—3RD FLOOR

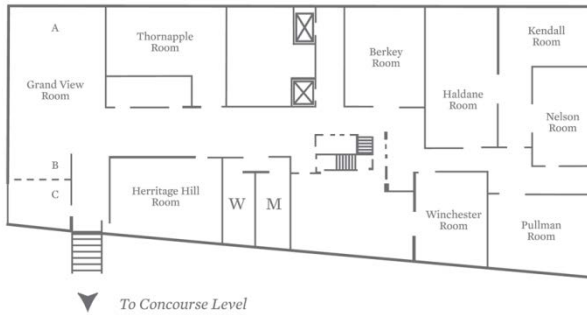

ATRIUM LEVEL—LOWER LEVEL

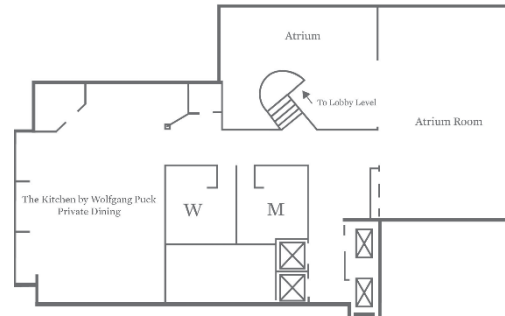

Room Name	Dimensions	Sq. Ft.	Ceiling	Banquet	Classroom	Reception	Theatre
Berkey	35' x 26'	910	8' 6"	50	60	115	88
Grand View	78' x 23'	1,821	8' 6"	130	96	225	132
Grand View A	36' x 26'	940	8' 6"	60	48	115	94
Grand View B	23' x 22'	506	8' 6"	30	24	60	48
Grand View C	17' x 22'	375	8' 6"	20	22	45	41
Haldane	47' x 25'	1,175	8' 6"	80	54	150	100
Herriage Hill	40' x 30'	1,220	8' 6"	80	42	125	80
Kendall	34' x 30'	1,165	8' 6"	70	58	130	80
Nelson	33' x 24'	792	8' 6"	50	40	100	72
Pullman	22' x 16'	385	8' 6"	20	21	50	36
Thornapple	41' x 24'	1,005	12'	70	40	90	64
Winchester	25' x 24'	701	8' 6"	50	35	90	50
Atrium	54' x 37'	1,998	9'	150	130	250	220

Destination Grand Rapids

Grand Rapids is one Cool City!



A **unique** place with urban sophistication and small town charm. A **vibrant downtown** alive with dining, entertainment, shopping and many cultural attractions.

Grand Rapids is a convenient destination where the JACoW 2016 Team Meeting can enjoy a first-class experience without paying premium prices.

Partners for Livable Communities calls Grand Rapids one of “America’s Best Places to Live, Work and Play.” They should have added “Visit,” because the same qualities that make Grand Rapids a great home also make us a great host. Friendly people, safe streets, breathtaking natural beauty and plenty of opportunities for fun ... they’re all part of the allure of Grand Rapids. It’s no wonder *Lonely Planet* named Grand Rapids and Michigan’s Gold Coast the **“Number One Place to Visit in 2014.”**

One of the most appealing qualities for visitors is convenience. Grand Rapids is easy to get to—and easy to get around, so you can fit more fun into less time. Our airport is served by five major airlines and offers 120 daily nonstop flights. Once you’re here, consider all you can do within a five-minute walk of DeVos Place, our downtown convention center: stroll 2.5 miles of riverwalk, visit **five museums**, work out at a deluxe new YMCA, picnic in a lush green park, catch a hockey game or stage show, cast a line into a salmon-rich river or browse more than 50 outdoor sculptures. Sidewalks are wide and heated in the winter to keep you safe when you are strolling around and shopping at one of our **40 downtown shops**. The temperature controlled skywalks throughout the city protect you from inclement weather and keep you perfectly dry when you are walking to the hotels, arena, or convention center.

Destination Grand Rapids

Just ten minutes from downtown is the splendor of the **Frederik Meijer Gardens & Sculpture Park**, a spectacular botanic garden and outstanding outdoor sculpture display. Also, about ten minutes away: championship golf courses, minor-league baseball, major-league shopping malls, fragrant fruit orchards, running and biking trails, stock car tracks and much more.

About 30 minutes from downtown, you'll encounter one of nature's greatest gifts: **Lake Michigan**. Here, you can sunbathe on miles and miles of clean, sandy beaches or explore charming coastal towns teeming with art galleries and distinctive boutiques.

Ride a dune buggy up one of America's tallest sand dunes or visit Michigan's largest amusement and water park. Wander through an authentic Dutch village complete with working windmill, and acres and acres of tulips in bloom.

Whatever you do, make sure to save time at the end of the day to sit back and enjoy one of the most glorious sunsets you'll ever see.

Yes, Grand Rapids is a great place to visit. It's no wonder that so many of our convention and meeting visitors "come early & stay late." We invite everyone involved in the JACoW 2016 Team Meeting to do the same!



About 30 minutes from downtown, you'll encounter one of nature's greatest gifts: **Lake Michigan**.

Destination Grand Rapids

Frederik Meijer Gardens & Sculpture Park



Michigan's second most popular tourist attraction...one of the world's 100 most visited art museums...one of the Top 30 Must-See Museums on the Planet.

These are just some of the accolades earned by Frederik Meijer Gardens & Sculpture Park. Just minutes from downtown Grand Rapids, this 132-acre haven integrates horticulture and sculpture throughout its site, setting it apart from other more traditional botanic garden or art museum experiences. View the grounds on foot or take a guided tram ride.

Garden Highlights

- Carnivorous Plant House
- Children's Garden
- English Perennial Garden
- Japanese Garden - opening 2015
- Tropical Conservatory
- Victorian Garden
- Woodland Shade Garden

Sculpture Park Highlights

- Midwest's most comprehensive outdoor sculpture collection
- Works from Rodin, Degas, Miro and many more
- Rotating exhibits dedicated to sculpture traditions of all periods

Annual Events

- Butterflies are Blooming - March-April
- Chrysanthemums and More! - September-October
- Christmas and Holiday Traditions Around the World - November-January

Summer Concert Series

An annual concert series runs June through August and features major artists like Santana, Lyle Lovett and The Beach Boys in a stunning outdoor setting.

Destination Grand Rapids

Grand Rapids Museums



These popular Grand Rapids Museums are all located within walking distance of each other and Downtown.

Grand Rapids Art Museum

The Art Museum's history extends back to 1910, but its current facility was erected in 2007. Newsweek magazine promptly named it one of the best buildings of the year: "This cool and modernist building ... is the first newly constructed 'green' museum in the United States."

Situated on the edge of Rosa Parks Circle - downtown's community square - GRAM has become one of the city's iconic architectural landmarks.

Gerald R. Ford Presidential Museum

Gerald Ford, the 38th President of the United States wasn't born in Grand Rapids - but he was raised here and represented the city in the U.S. House of Representatives from 1949-1973. He also served in the United States Navy from 1942-1946 when he was released under honorable conditions as a Lieutenant Commander. All of this and more is brought to engaging life at the Gerald R. Ford Presidential Museum in downtown Grand Rapids.

Permanent exhibits include a full-scale replica of the Oval Office, a Watergate gallery, interactive Cabinet Room, 1976 Bicentennial display, and a section of the Berlin Wall. Additional exhibits pay tribute to the life and influence of Betty Ford.

The President and Mrs. Ford are buried on the grounds of the Museum, on a hillside spot that attracts a steady stream of people paying their respects to our native son and his dear wife.

Grand Rapids Public Museum

Founded in 1845, the Grand Rapids Public Museum is among the oldest history museums in the United States. Not that you'd be able to tell from its sparkling facility, which rises three stories above the downtown riverfront. Inside, a fascinating panorama of permanent collections and temporary exhibits preserve the treasures of the past and the present.

Transportation

For attendees who will travel to the JACoW 2016 Team Meeting by air, Grand Rapids provides easy accessibility and convenience. The **Gerald R. Ford International Airport (GRR)**, ranked by Airports Council International as one of the top five best airports in the world (by size), is served by six major airlines and offers 120 daily nonstop flights. Adjacent to two major arteries, the airport is only 15-20 minutes from our wide range of hotels and meeting facilities located in the downtown district or any corner of the city.

Whether coming from near or far, you can get to and from Grand Rapids on nonstop flights from 24 major market destinations:

Atlanta
Baltimore
Charlotte
Chicago-O'Hare
Dallas/Fort Worth
Denver

Detroit
Ft. Lauderdale
Fort Myers
Houston
Las Vegas
Minneapolis/St. Paul

New York – La Guardia
New York – Newark
Orlando International
Orlando – Sanford
Philadelphia
Phoenix/Mesa

Punta Gorda
St. Louis
St. Petersburg/Clearwater
Tampa International
Washington D.C.

National and regional airlines that fly to Grand Rapids are:

- Allegiant Air
- American Airlines/
American Eagle
- Delta Air Lines
- Southwest Airlines
- United Airlines
- US Airways



Getting there is better here.



The Scenic Route. To attend the JACoW 2016 Team Meeting **and** see more of America, Grand Rapids is also easily accessible by train or car. Amtrak serves Grand Rapids with a direct line from Chicago, showcasing Michigan's beautiful west coast. Interstates 96 and 196 converge in Grand Rapids, as does Michigan highway 131, making us convenient to get to from north, east, south and west.

Convention Services

.....
Grand Response™. It's not just a slogan, it's our branded approach to offering outstanding convention services. It's tangible—it's effective—and it's free!

Our Convention Service Managers are Certified Meeting Professionals (CMP). They know meetings. They know planners. They know Grand Rapids. You know what your group wants and needs. Together, you can make your upcoming meeting the best yet! They will work with you via phone, email and personal visits to customize a meeting experience that satisfies your specific goals. They have tons of ideas and want to brainstorm with you to ensure the success of the JACoW 2016 Team Meeting.

Our online, [on-demand planning tools](#) help you research and select local service providers and can provide you with maps and diagrams, travel information, and facility options for off-site events. Visit our [website](#) to explore the services available. These self-help tools, combined with one-on-one planning assistance from our Grand Response™ Convention Service Managers, give you all the information you need to plan a successful event.

You can also get great information by keeping up with our [Meeting Minds blog](#), a site that provides tips, articles and thought leadership on the subject of meeting planning. We even introduce you to *GREG*, the *Grand Rapids Event Guide* book. This guide offers a wealth of information for novice coordinators as well as experienced meeting planners.

Another exciting service we offer is a [microsite](#), a web page customized for your event. Attendees can visit this custom webpage to learn about your meeting as well as Grand Rapids information before they attend the JACoW 2016 Team Meeting.

All of these services are **complimentary** for the JACoW 2016 Team Meeting.

Here are several of the ways that our Grand Response™ Convention Service Managers can help. They will:

- Plan and organize site inspections
- Create attendance-building promotions
- Organize on-site activities and entertainment

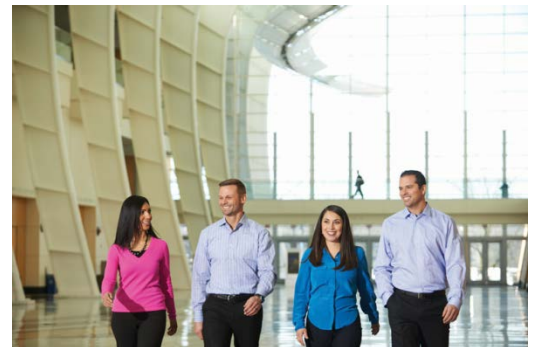

Meet Your Sales Manager

Nichole Steele, CTA
National Sales Manager

NSteele@ExperienceGR.com

(616) 233-3547

(800) 678-9859 ext. 3547

As your designated sales manager, **Nichole** will be your one-stop-shop for everything related to helping you plan the JACoW 2016 Team Meeting. She reviews rates, collects proposals, suggests facilities and sets up site inspections. Listening closely to your needs is the biggest part of Nichole's job. As an expert on all that Grand Rapids has to offer, she is well suited to match up your unique requirements and preferences with the perfect venue and hotel solution.

Besides helping you find your facility, Nichole works closely with our services team to ensure you have a successful meeting.

Degrees/Certifications: Certified Tour Ambassador (CTA)



Meet Your Services Manager

Tim Nelson (CMP, GMS, CTA)
Convention Services Manager

TNelson@ExperienceGR.com

(616) 233-3556

(800) 678-9859 ext. 3556

Tim specializes in convention services for national and regional events. As your convention services manager, **Tim** offers planning assistance, marketing and communications support, attendance building and coordination of on-site services. Besides helping you manage your meeting, he works closely with our sales team to ensure we fulfill all the promises we make to you.



Degrees/Certifications: Certified Meeting Professional (CMP), Government Meeting Specialist (GMS), Certified Tourism Ambassador (CTA)

Professional Affiliations: Michigan Society of Association Executives (MSAE), Event Service Professionals Association (ESPA)

Appendices





City of Grand Rapids, Michigan
OFFICE OF THE MAYOR

GEORGE K. HEARTWELL
MAYOR

December 15, 2015

Ms. Amy McCausey
Project Coordinator II
MSU Facility for Rare Isotope Beams
640 South Shaw Lane
Office 2135
East Lansing, MI 48824

Dear Ms. McCausey:

I was pleased to learn that the MSU Facility for Rare Isotope Beams is considering holding your JACoW 2016 Team Meeting in Grand Rapids. On behalf of our community, we look forward to the prospect of hosting your organization and creating a successful and memorable event for each and every attendee.

As Mayor, I'm proud of our city's many qualities and our people's commitment to visitors like the MSU Facility for Rare Isotope Beams. Despite this obvious prejudice, please trust me when I express my confidence that Grand Rapids offers more benefits, amenities and options than any other site you may be considering.

Your attendees will love the "walkability" of our downtown at all times of day or evening. We have the fastest growing entertainment district in the state and offer many different types of music, theater and sporting events—and our shopping is *unbelievable!*

Beyond downtown, most anything else you would want to see and do can be found within a short twenty-minute drive. Only 30 miles away are picturesque coastal towns with a variety of art galleries, boutiques, golf courses—and of course, beaches.

We make it so easy to plan and execute a successful event. You will find that the Experience Grand Rapids team provides professional, personalized service and works hard to ensure your satisfaction. Moreover, I assure you that your staff will enjoy the full cooperation of our Convention & Visitor's Bureau as well as the various departments at City Hall.

With the hope that you will allow us to host the JACoW 2016 Team Meeting, let me be the first to welcome you to Grand Rapids.

Very Truly Yours,

George Heartwell



December 15, 2015

Ms. Amy McCausey
Project Coordinator II
MSU Facility for Rare Isotope Beams
640 South Shaw Lane
Office 2135
East Lansing, MI 48824

Dear Ms. McCausey:

Grand Rapids is an ideal place to hold the JACoW 2016 Team Meeting. During your event, attendees will enjoy some of the best meeting facilities in the nation; and during off hours, they will have easy access to a wide array of leisure, entertainment and cultural opportunities catering to every interest.

I'm thrilled to know that you are exploring all that Grand Rapids has to offer. As you go through your site selection process, here are five key reasons why I believe we are the right choice for the MSU Facility for Rare Isotope Beams.

Meeting Time: We have five distinct event sectors that offer a range of options to accommodate your group's interests and logistical preferences. Whatever venue you choose, the convenience and modern amenities of our facilities will support your meeting's goals.

Play Time: Grand Rapids has so much to see and do. In downtown alone we have over 90 restaurants and nightclubs, as well as many options for live music, theatre, shopping, sporting events and more. We've even been voted as Beer City USA two years in a row, with fantastic breweries and brewpubs at every turn.

Hospitality: Grand Rapids is a *Cool City*—impressive, yet cozy. You'll feel the fun and hospitality during your entire stay.

Convenience: Traveling to Grand Rapids is simple, and once you're here you'll find that it's easy to get to all your event locations and extracurricular activities.

Team Spirit: Hotels, restaurants, meeting venues and merchants all get along famously. The camaraderie of our big, happy family ensures that you will have a pleasant, productive and rewarding experience at the JACoW 2016 Team Meeting.

All of this and more awaits you in Grand Rapids. We hope to see you soon.

Sincerely,

A handwritten signature in black ink, appearing to read "Doug Small". The signature is stylized with loops and a long horizontal stroke extending to the right.

Doug Small
President

Great Lakes Region



Downtown Campus Map

View [Online Map](#)

DOWNTOWN GRAND RAPIDS



Grand Rapids' Recognitions

The Latest Honors for Grand Rapids!

One of America's Top 10 Most Exciting Mid-Sized Cities, *Movoto*
March 2014

#1 Travel Destination for 2014, *Lonely Planet*
December 2013

Beer City, U.S.A., *Examiner.com*
May 2012 & 2013

15 U.S. Cities' Emerging Downtowns, *Forbes.com*
May 2013

Top 8 North American City Experiencing an Artistic Boom, *Good*
March 2012

2nd Best Place to live in the US, *Wall Street Journal Market Watch*
August 2011

#1 LEED-certified buildings per capita for mid-size U.S. cities, *American Institute of Architects*
2010

USGBC recognizes the Greater Grand Rapids area as having the most LEED Fellows per capita, *U.S. Green Business Council (USGBC)*
Fall 2014

References

We can confidently tell you that Grand Rapids will exceed your expectations. But don't just take our word for it. We host hundreds of groups each year and will gladly put you in touch with other people who have selected our wonderful city for their events.

- **Ms. Chris Anderson**, Conference & Corporate Relations Manager for the American Jail Association
- **Ms. Karen Voytecki**, Executive Director of the Teacher Education Division -Council for Exceptional Children
- **Mr. David Ivan**, Conference Committee Co-Chair for the National Association of Community Development Extension Professionals